



INCO ENGINEERING

Inco Engineering, C/o J.B. Metal Compound, Opp Hotel Savoy, Sakivihar Road, Sakinaka, Andheri (E), Mumbai 400072 INDIA.

Tel.: 022 28473821 / 022 28478955
Telfax: 022 28473821
Hand Phone: +91 9821048955
E-mail: rakesh@incoengineering.in
URL: www.incoengineering.in

www.incoentepries.com



CLAMPS FOR DRY CLADDING

BRACKETS FOR GLASS GLAZING
& ACP CLADDING

NUT BOLTS & SCREWS

ANCHOR FASTENERS

RAILING WORKS



INCO ENGINEERING

Corporate

Be Visible

INCO steel Engineering in the business of Stainless Steel Fasteners for past 20 years. Our products are ISO certified and made as per Customer specifications. With our modern equipments, workshop facility and dedicated work force; we are able to meet customers' demand on time every time.

Highest quality of products & Prompt delivery are always been priority at INCO. We have integrated manufacturing for critical fasteners with ability to supply small / medium / large batch of quantities of standard / tailor made. With our network across India and automated packaging facility we are in a position to offer timely deliveries across India.

Our experience has resulted in developing of various products used by Architects, Railways, Major Electricity Boards, Consumer Industries, Home Appliances, Electronic Industries etc.

Be In Mind,

Be In Business

Products

Clamps for Granite Dry Cladding
Bracket for Glass ACP Cladding Facade work
Nut Bolts, Screws & Anchor Fasteners

- Self drilling screws & self tapping
- Allen head grub screw
- Hex/ Square/ Fly/ Slotted bolts & screws
- Square/ Countersunk/ Flat machine screws
- Threaded Spindle/ Pins/ Screws
- Threaded clamps
- Wood screws

Anchor Fasteners

- Rawal anchor for brake wall
- Thru bolt for RCC

Railing Works in Stainless Steel

Other Products

- Full threaded bars
- Full threaded studs



Infrastructure

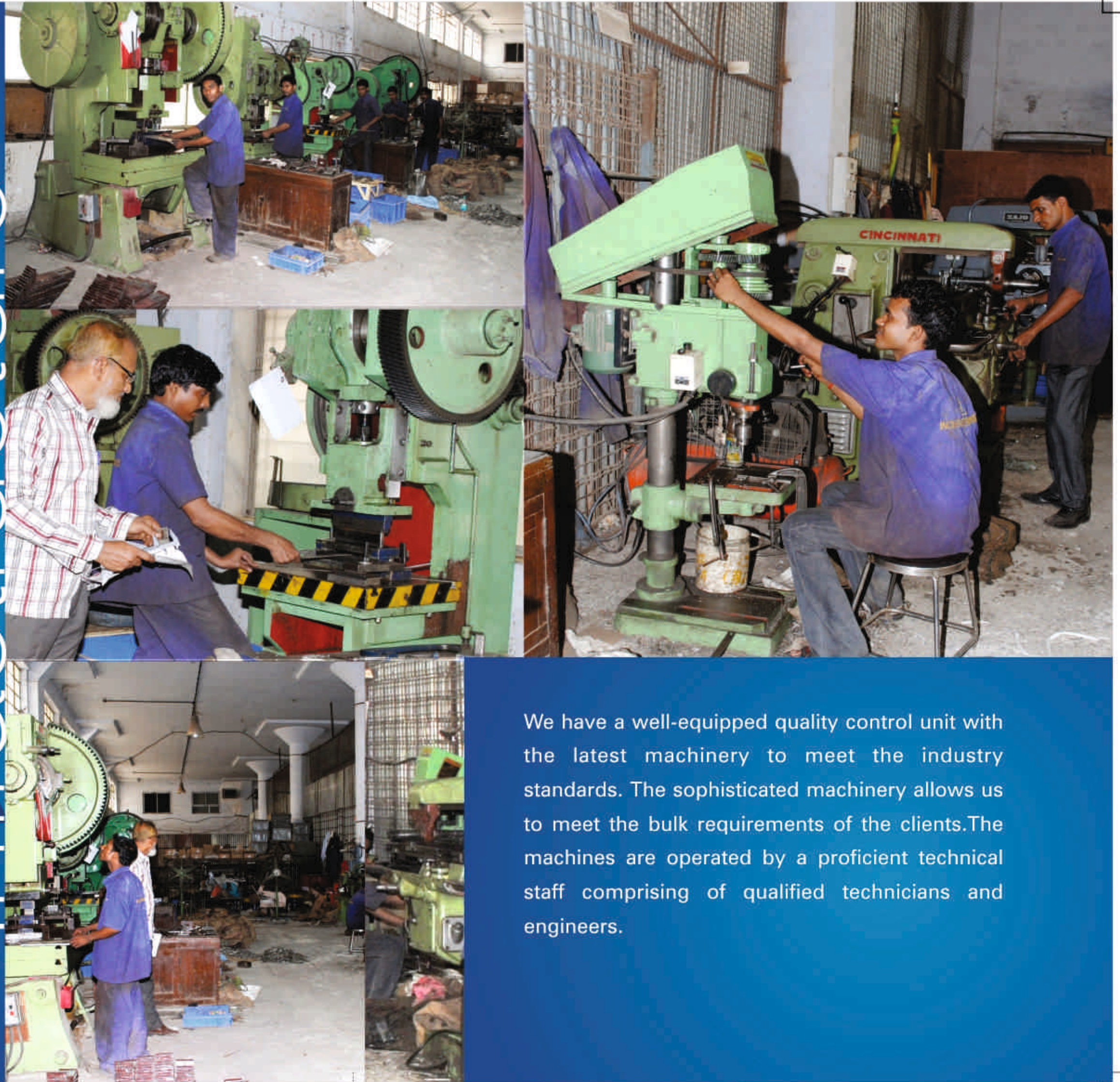

We have a well-equipped quality control unit with the latest machinery to meet the industry standards. The sophisticated machinery allows us to meet the bulk requirements of the clients. The machines are operated by a proficient technical staff comprising of qualified technicians and engineers.

Anchor Fasteners



DESCRIPTION

- Suitable to use in concrete to medium to heavy load
- The one-piece clip is formed around Anchor, assuring full expansion for dependable, superior holding power
- Expanding clip will not fall off or twist in the hole
- Fast and efficient through fixing Economical for wide range of fastening application
- Ideal for pipe suspension, foundation work, Aluminium glazing system, window support systems
- Available in Galvanized steel, Stainless Steel A2/ 304 & A4/ 316 Material

The test values listed below were obtained using 200-250kgs/cm concrete (M20-M25). A safe working load should not exceed 25% of stated values.

Sr No.	Anchor Size	Threading Length (mm)	Max. Fixture thickness (mm)	Drill hole Dia x depth (mm)	Setting Depth (mm)	Pull out Load (Kgs)
1	M8 x 75	28	15	8x60	50	800
2	M8 x 100	32	40	8x60	50	800
3	M10 x 75	28	10	10x60	(50)	1000
4	M10 x 100	32	20	10x70	60	1200
5	M10 x 125	36	40	10x70	60	1200
6	M10 x 150	36	65	10x70	60	1200
7	M12 x 75	28	5	12x60	(50)	1200
8	M12 x 100	32	10	12x80	(70)	1500
9	M12 x 125	36	30	12x90	80	1700
10	M12 x 150	36	55	12x90	80	1700
11	M16 x 100	40	15	16x90	(80)	2300
12	M16 x 150	50	20	16x110	100	2800
13	M16 x 180	50	50	16x110	100	2800
14	M16 x 200	50	70	16x110	100	2800
15	M20 x 150	50	15	20x110	100	3500
16	M20 x 180	50	45	20x110	100	3500
17	M20 x 200	50	80	20x110	100	3500



STRUCTURAL BOLTS: Heavy Hex, Tension Control, Heavy Hex Nuts & Washers

- ASTM A325 Type I Standard
- ASTM A325 Type III Weathering
- ASTM A490 150,000 Min. Tensile
- A449 Gr. 5
- Heavy Hex Head, Button Head Shear and Slotted Countersunk Bolts
- 1/2" Through 1 1/2" in Diameter
- Specials, made to customer's drawings
- Standard and Special Lengths Available
- In Stock in Our Warehouse
- Plain, Hot Dip Galvanized or Mechanical Galvanized
- A563 Gr. DH, Gr. A, A194 Gr. 2H Heavy Hex Nuts
- Direct Tension Indicator Washers ASTM F959
- Electric Wrenches for Shear Bolts and Heavy Hex Bolts
- Sales, Repairs and Replacement Parts for Wrenches
- Job site Bolt Tension Calibration Inspections
- In House Rotational Capacity Testing
- Complete Mill Traceability and Certification Available
- F436 Heavy Structural Washers

Bracket and Clamps



INCO 01



INCO 02



INCO 06



INCO 07



INCO 03

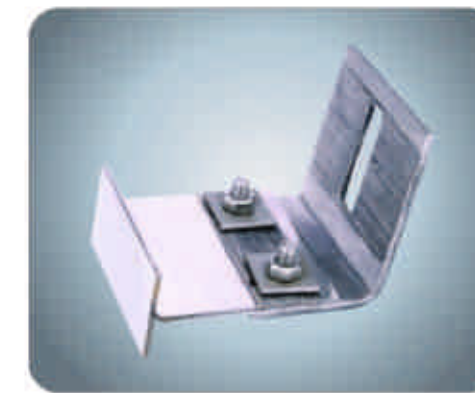

INCO 08



INCO 09



INCO 04



INCO 10

- Bracket and Clamps made in M.S. & Stainless Steel
- M.S. Brackets Hot Dip Galvanized / Painted
- Stainless Steel Brackets & Clamps in 304, 316 grades with Brush and Glossy finish
- Dry Cladding Clamps in Standard & Customized sizes are available



INCO 05



INCO 11



INCO 12

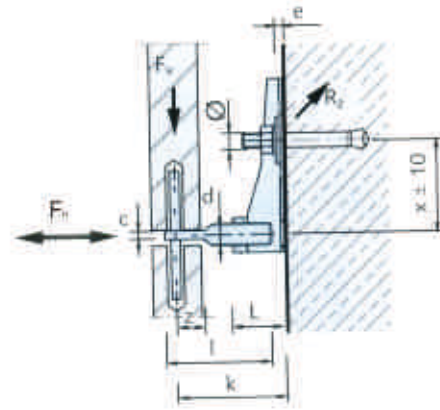
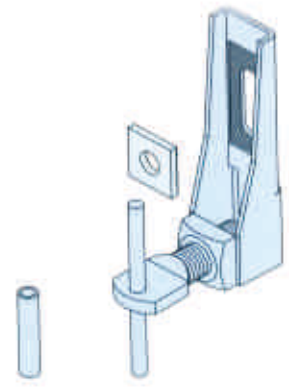

The Inco Anchor has been designed for short projections of 60 mm to 120 mm and large loads up to 1300 N. It consists of a rugged base body, a toothed washer and a threaded spade bolt.



Applications

